

1250-4 VERTICAL STYLE MAILBOX

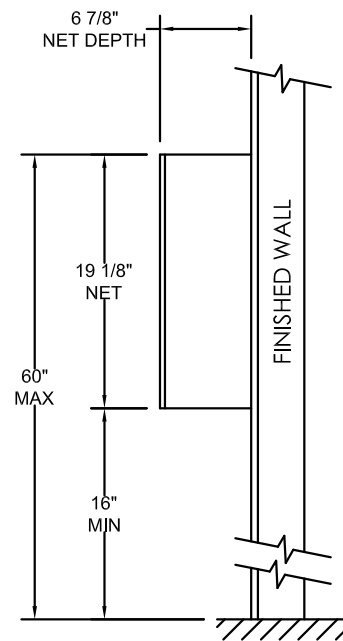

FINISHED FLOOR
(SURFACE MOUNT)

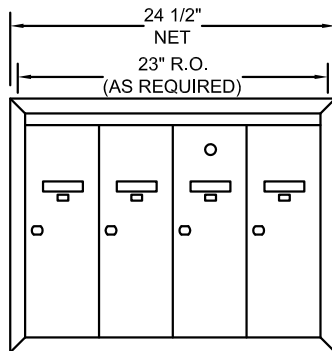
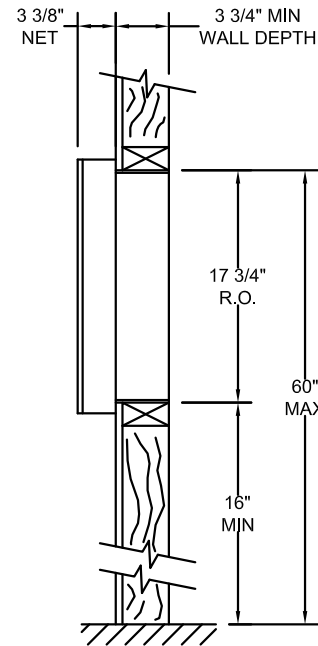

FINISHED FLOOR
(SEMI-RECESS MOUNT)

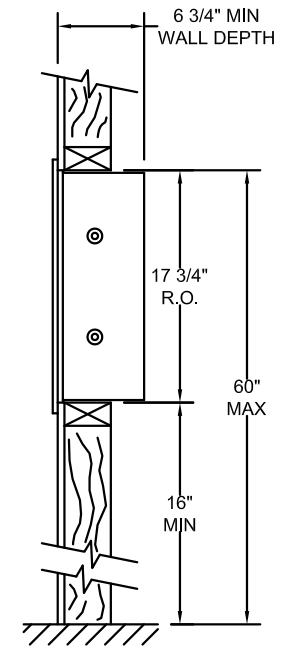

FINISHED FLOOR
(RECESS MOUNT)

NOTES:

STANDARD:

- (1) 1250-4 SERIES ALUMINUM CABINET WITH (3) STANDARD SIZE DOORS (16"H X 5 1/2"W), AND (1) STANDARD SIZE MASTER DOOR PREPARED FOR POSTAL MASTER LOCK.
- CLEAR ANODIZED FINISH.
- 5-PIN CYLINDER CAM TYPE LOCK WITH (2) KEYS EACH.
- TENANT NAME CARD HOLDER ON EACH DOOR.
- RECESSED MOUNT (NO COLLAR REQUIRED).
- UNIT WEIGHT: 25 POUNDS.

OPTIONAL:

- PRIVATE MASTER LOCK.
- POWDER COAT FINISH AVAILABLE IN 10 COLORS.
- ENGRAVING OR BLACK-FILLED ENGRAVING ON EACH DOOR.
- OPTIONAL DOORS SIZES AND ARRANGEMENTS.
- SURFACE MOUNT (WITH SM125-4 COLLAR); SEMI-RECESSED MOUNT (WITH SR120-4 COLLAR).
- INTEGRAL DIRECTORIES.
- INTEGRAL DOORBELL PUSH BUTTONS.
- DOUBLE ROW INSTALLATION (MAINTAIN MAX AND MIN INSTALLATION DIMENSIONS AS SHOWN ON CS5048).

PRODUCT SERIES:

1250-4 VERTICAL STYLE MAILBOX

AF FLORENCE
manufacturing company

5935 Corporate Drive • Manhattan, KS 66503
www.florencemailboxes.com • (800) 275-1747

A GIBRALTAR INDUSTRIES COMPANY

MODEL 1250-4	REV D
SCALE NONE	LAST REV DATE 8/24/2012
DRAWING NUMBER CS5051	DRAWN BY RAK